

Shaping Inspiration

ROSSKOPF
+ PARTNER



PRODUCT LIST

lavanto®

2016

Form Parts

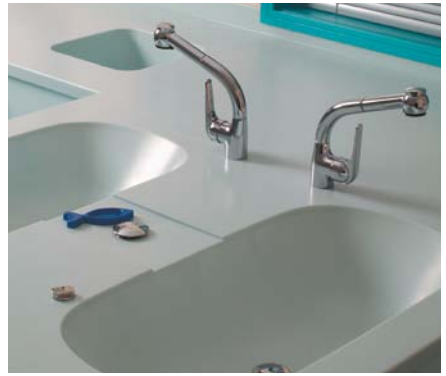

Contents

	PRELIMINARY INFORMATION	4-5
General Information	PRODUCT LIST FORM PARTS	
	Colour Group Overview Avonite®	8
Sinks	lavanto® Sinks made of Solid Surface Material	12-18
	lavanto® Cast Sinks made of Solid Surface Material	19-20
	EDGE SINKS® Basins	21-23
Bowls	lavanto® Bowls made of Solid Surface Material	26-40
	lavanto® Cast Bowls made of Solid Surface Material	41
	lavanto® Top-mount Basin with Pedestal	42-44
Medical Bowls and Bathtubs	lavanto® Medical Bowls and Bathtubs made of Solid Surface Material	48-49
Shower Trays	lavanto® Shower Trays made of Solid Surface Material	52-53
Accessories	Accessories Sinks	55
	Accessories Shower Trays	55
	COLOUR CHART	
	Solid Surface Material Avonite®	58-61
	GENERAL INFORMATION	
	Delivery Conditions	64
	Warranty – lavanto®	65
	Instructions for Use – lavanto®	65



The Best Tools for the Best Results.

For perfect planning, you need to have all the crucial information available in a clear format.

Therefore, we bundled and structured all the information and facts you need as well as useful tools and useful Information for you in this Product List.

To allow you to have the maximum benefit from the information, we will explain the structure at the beginning of this document.

Material and Form Parts Assortment

This Product List has one focal point: our entire assortment of form parts for kitchens, bathrooms and other areas (pages 12-53).

Information on Ordering and Delivery, Terms and Conditions

At the end of this document, we have summarized important information about our ordering and delivery process as well as our general delivery conditions for you (page 64). Depending on the material, please note that there may be individual differences in some aspects.

Let's talk with each other!

If you have any unanswered questions about this product list, or if you need more personal support, our team in the office and our field staff are always pleased to assist you at any time.

In this regard:

We look forward to a good partnership!



Helmut Rosskopf, Founder and CEO of Rosskopf + Partner in a conversation with an employee.

A photograph of a kitchen sink area. A person's arm is visible on the right side, reaching towards a white sink. A white cloth is draped over the left side of the sink. The countertop is light-colored with a speckled pattern. A dark wood-grain backsplash is visible behind the sink. The floor is dark grey with a herringbone pattern.

PRODUCT LIST lavanto®2016

Form Parts

SOLID SURFACE MATERIAL

The incredible possibilities of this material fascinate our customers over and over again: Homogeneous joint-free surfaces, exciting lighting effects and, especially, completely versatile thermoformability allow the designs of creative architects to become increasingly more spectacular.

COMPOSITION

Aluminium-hydroxide, high-quality acrylic and pigments

AESTHETIC FEATURES

- Gap-free joining of sheets and basins or bowls (no dirty edges, perfect hygiene)
- Invisible transitions for the impression of a massive single object
- Individually thermoformable with unchanged material properties
- Translucent: The material can be relief-milled first and then backlit for special effects.

TECHNICAL SPECIFICATIONS

- Resistant to all common household chemicals and food
- Resistant to water, dirt and moisture
- Can be repaired easily if damaged
- UV-resistant

COLOURS

- Available in 76 colours





Solid Surface Material – Colour Group Overview Avonite® Form Parts

Colour Group	Colour No.	Colour Name	Colour Group	Colour No.	Colour Name
SOLIDS	F1-8026	Super White	STRUCTURED	F1-7810	Malt
	F1-8090	Snowfall		F1-7820	Star Shine
	F1-8256	Polaris		F1-7826	Signal
	F1-8010	Bone		F1-7830	Bronze
	F1-8024	Crème		F1-8206	Alpine Shimmer
	F1-8064	Ice White		F1-9010	Stormy Gray
	F1-8066	Porcelain		F1-9020	Black Lava
	F1-8106	Ivory		F1-9036	Sandstorm
	F1-8240	Eclipse		F1-9037	High Desert
	F1-8252	Orange Zest		F1-9065	Artica
	F1-8254	Green Apple		F1-9105	Aspen
	F1-8258	Antique Blue		F1-9117	Kokoura
	F1-8260	Rain		F1-9125	Black Coral
	F1-8262	Vino		F1-9137	Casablanca
	F1-8264	Crimson		F1-9144	Palermo
	F1-8266	Fondant		F1-7711	Jurassic
	F1-8268	Mango		F1-7735	Dark Roast
	F1-8272	Café au Lait		F1-7921	Boardwalk
	F1-8274	Sugar Cane		F1-7931	Cliffside
	F1-8276	Brume		F1-7501	Moon Crystal
	F1-8278	Clay		F1-7502	Avalanche
	F1-8280	Smoke		F1-7503	Morning Tundra
	F1-8282	Carbon		F1-7555	Icecap
	F1-8284	Azul		F1-7556	Shark Skin
	F1-8286	Cardamom		F1-7557	Hazelnut
	F1-8288	Putty			
	F1-8290	Plumbic			
	F1-8292	Cloud			

Form Parts in the Studio Collection by request.



Notes:

Collection

The **Roskopf + Partner Collection** is particularly tuned to the requirements of our customers and are specially marked (**colour name**) in our overview. These colours are continually available in stock so that we can provide you with improved production and delivery times.

Dark and matte colours show dust and dirt more easily than light and textured colours. Therefore, they require more frequent cleaning.





PRODUCT LIST lavanto® 2016

Sinks





lavanto® – SINKS MADE OF SOLID SURFACE MATERIAL

ISEO

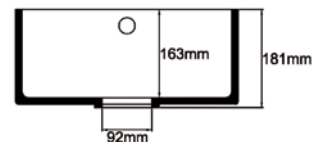
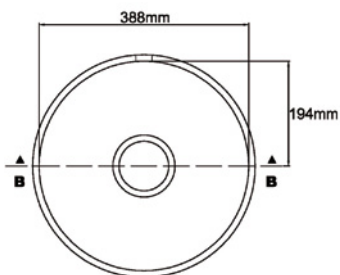

Description

Article no.

with overflow incl. overflow set

LS388C-H-0

without overflow

LS388C-H-1

CALDO

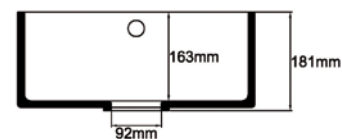
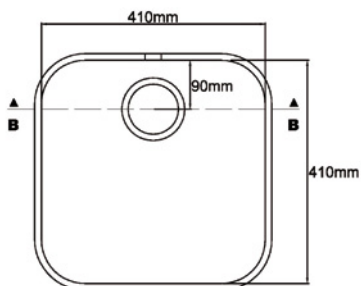

Description

Article no.

with overflow incl. overflow set

LS410C-H-0

without overflow

LS410C-H-1

VICO

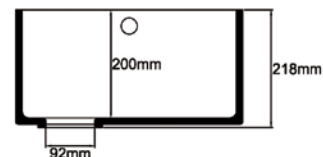
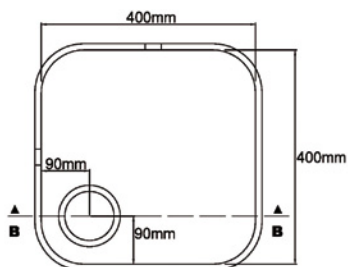

Description

Article no.

with overflow incl. overflow set

LS400C-H-0

without overflow

LS400C-H-1

Compatible drain fittings can be found on page 55 under Accessories.

lavanto® – SINKS MADE OF SOLID SURFACE MATERIAL

ORTA

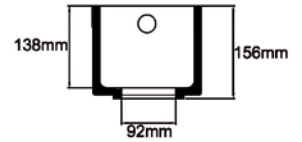
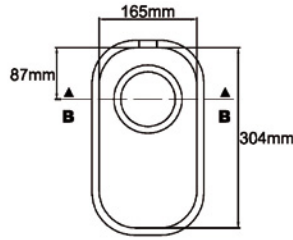

Description

Article no.

with overflow incl. overflow set

LS304C-H-0

without overflow

LS304C-H-1

FONDI

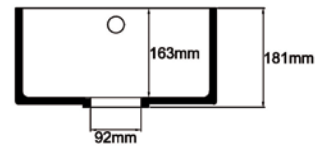
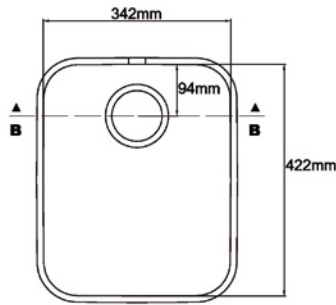

Description

Article no.

with overflow incl. overflow set

LS422C-H-0

without overflow

LS422C-H-1

GARDA

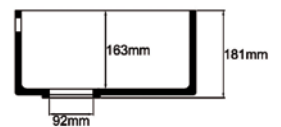
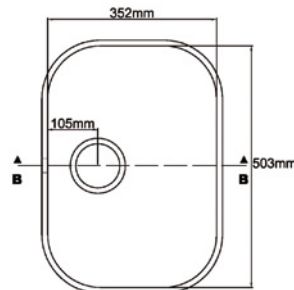

Description

Article no.

with overflow incl. overflow set

LS503C-H-0

without overflow

LS503C-H-1

Compatible drain fittings can be found on page 55 under Accessories.

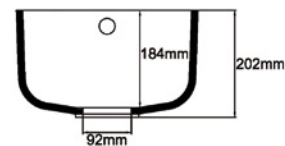
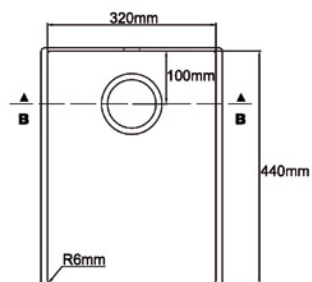

lavanto® – SINKS MADE OF SOLID SURFACE MATERIAL

MUTA 320-440***Description****Article no.**

with overflow incl. overflow set

LS320-440C-H-0

without overflow

LS320-440C-H-1

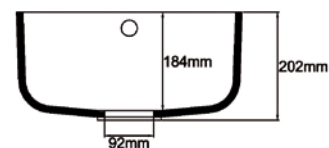
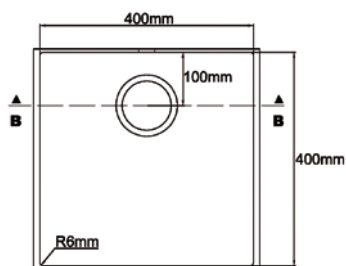
MUTA 400-400***Description****Article no.**

with overflow incl. overflow set

LS400-400C-H-0

without overflow

LS400-400C-H-1

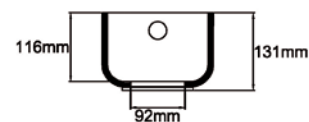
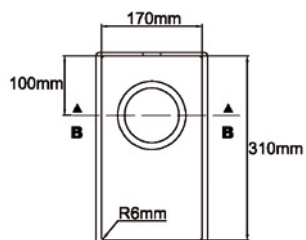
PIANI 170-310***Description****Article no.**

with overflow incl. overflow set

LS170-310C-H-0

without overflow

LS170-310C-H-1

* This sink is available only in a limited colour range!
Compatible drain fittings can be found on page 55 under Accessories.

lavanto® – SINKS MADE OF SOLID SURFACE MATERIAL

PIANI 170-400*

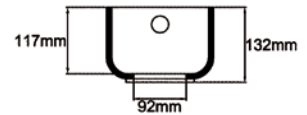
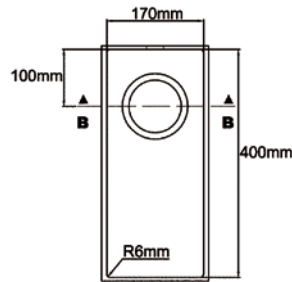

Description

Article no.

with overflow incl. overflow set

LS170-400C-H-0

without overflow

LS170-400C-H-1

PIANI 170-440*

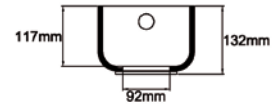
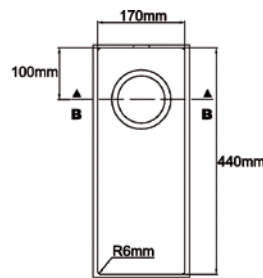

Description

Article no.

with overflow incl. overflow set

LS170-440C-H-0

without overflow

LS170-440C-H-1

ARIE 500-330*

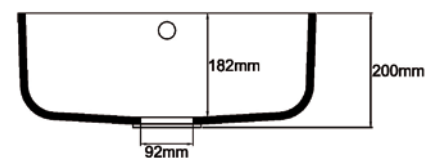
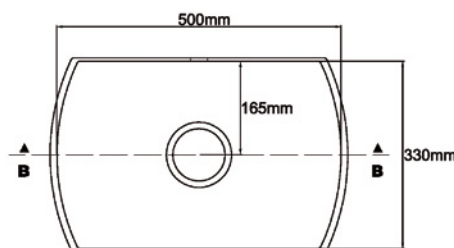

Description

Article no.

with overflow incl. overflow set

LS500-330C-H-0

without overflow

LS500-330C-H-1

* This sink is available only in a limited colour range!
Compatible drain fittings can be found on page 55 under Accessories.

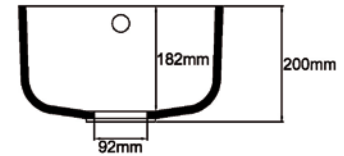
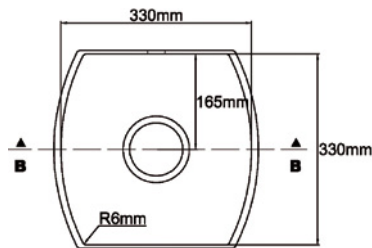
**lavanto® – SINKS MADE OF SOLID SURFACE MATERIAL****ARIE 330-330*****Description****Article no.**

with overflow incl. overflow set

LS330-330C-H-0

without overflow

LS330-330C-H-1

NEVES 165-250*

Please indicate whether this sink is to be installed with fittings on the left or right side.

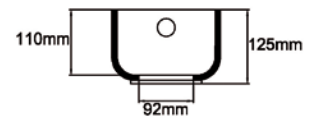
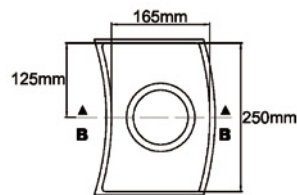
**Description****Article no.**

with overflow incl. overflow set

LS165-250C-H-0

without overflow

LS165-250C-H-1

IDRO 500-400

Sink with stainless steel bottom

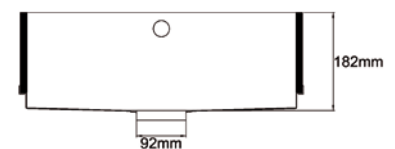
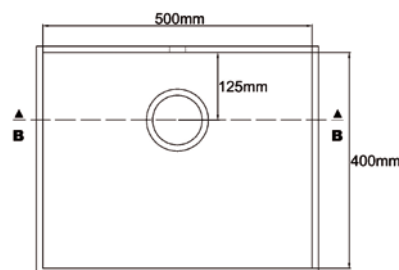
**Description****Article no.**

with overflow incl. overflow set

LS500-400I-H-0

without overflow

LS500-400I-H-1

* This sink is available only in a limited colour range!
Compatible drain fittings can be found on page 55 under Accessories.

lavanto® – SINKS MADE OF SOLID SURFACE MATERIAL

IDRO 400-400

Sink with stainless steel bottom

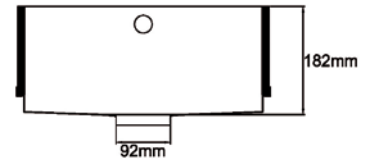
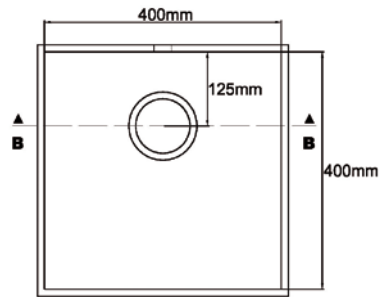

Description

Article no.

with overflow incl. overflow set

LS400-400I-H-0

without overflow

LS400-400I-H-1

IDRO 200-400

Sink with stainless steel bottom

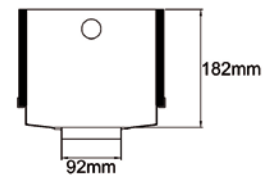
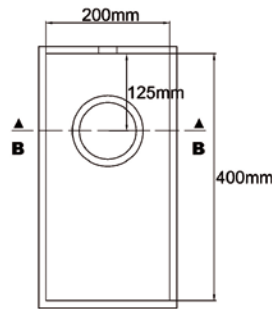

Description

Article no.

with overflow incl. overflow set

LS200-400I-H-0

without overflow

LS200-400I-H-1

IDRO SOFT 200-400

Sink with stainless steel bottom, Radius of the inner corners 12 mm

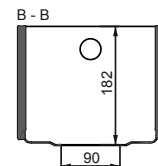
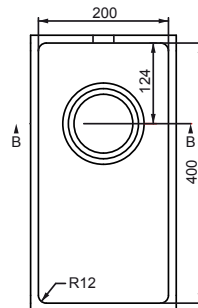

Description

Article no.

with overflow incl. overflow set

LS200-400I-S-H-0

without overflow

LS200-400I-S-H-1

Compatible drain fittings can be found on page 55 under Accessories.



lavanto® – SINKS MADE OF SOLID SURFACE MATERIAL

IDRO SOFT 340-400

Sink with stainless steel bottom, Radius of the inner corners 12 mm

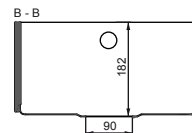
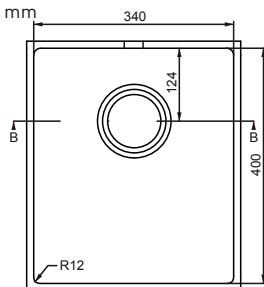

Description

Article no.

with overflow incl. overflow set

LS340-400I-S-H-0

without overflow

LS340-400I-S-H-1

IDRO SOFT 400-400

Sink with stainless steel bottom, Radius of the inner corners 12 mm

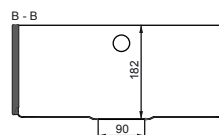
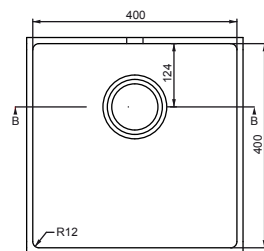

Description

Article no.

with overflow incl. overflow set

LS400-400I-S-H-0

without overflow

LS400-400I-S-H-1

IDRO SOFT 500-400

Sink with stainless steel bottom, Radius of the inner corners 12 mm

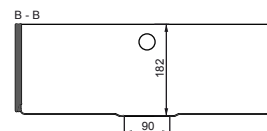
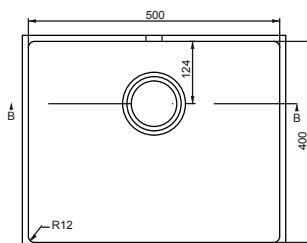

Description

Article no.

with overflow incl. overflow set

LS500-400I-S-H-0

without overflow

LS500-400I-S-H-1

Compatible drain fittings can be found on page 55 under Accessories.

lavanto® – CAST SINKS MADE OF SOLID SURFACE MATERIAL

VARRO*

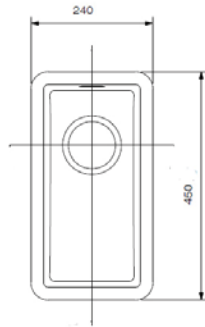

Description

Article no.

with overflow

LS190-400A-0

VISOLO*

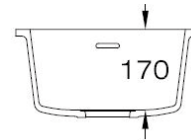
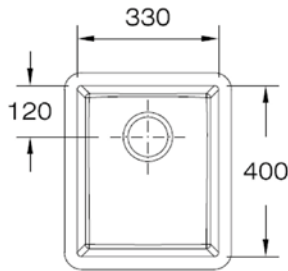

Description

Article no.

with overflow

LS330-400A-0

PELMO*

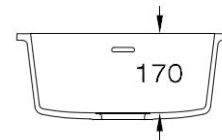
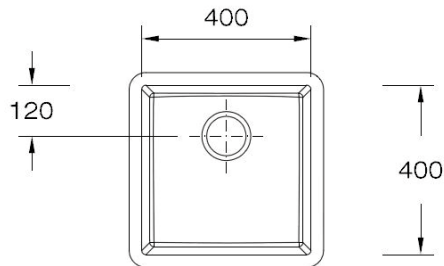

with overflow

LS400-400A-0

* This sink is available only in colour F1-8256 Polaris!
Compatible drain fittings can be found on page 55 under Accessories.



lavanto® – CAST SINKS MADE OF SOLID SURFACE MATERIAL

LIVRIO*

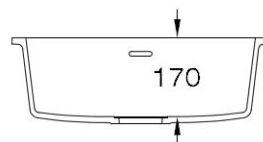
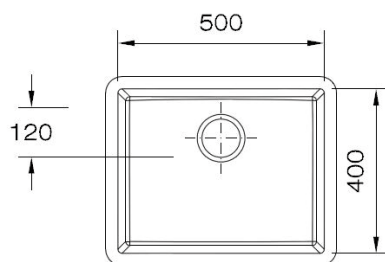

Description

Article no.

with overflow

LS500-400A-0

ZENARI*

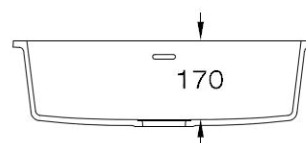
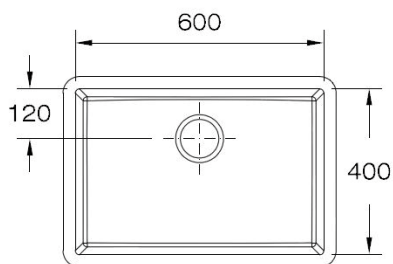

Description

Article no.

with overflow

LS600-400A-0

* This sink is available only in colour F1-8256 Polaris!
Compatible drain fittings can be found on page 55 under Accessories.

EDGE SINKS® – STAINLESS STEEL SINKS that can be integrated seamlessly



PRFE 100

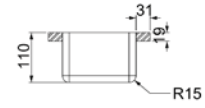
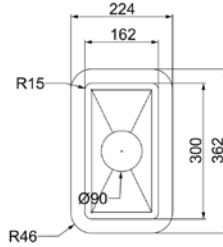

Description

Article no.

inside dimension: 162 x 300 x 110 mm
without overflow

PRFE100

PRFE 200

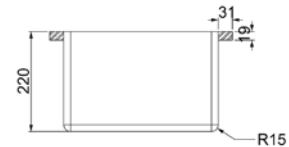
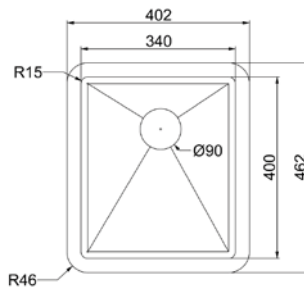

Description

Article no.

inside dimension: 340 x 400 x 220 mm
with overflow

PRFE200

PRFE 280

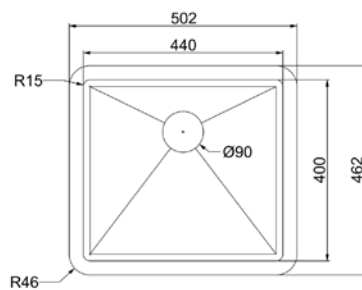

Description

Article no.

inside dimension: 440 x 400 x 220 mm
with overflow

PRFE280



EDGE SINKS® – STAINLESS STEEL SINKS that can be integrated seamlessly



PRFE 300

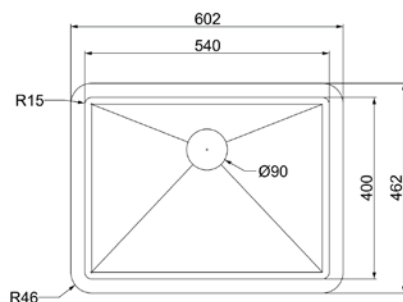

Description

Article no.

inside dimension: 540 x 400 x 220 mm
with overflow

PRFE300

PRFE 350L

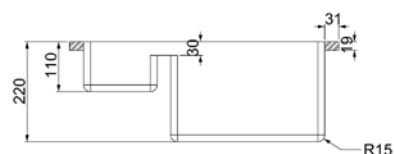
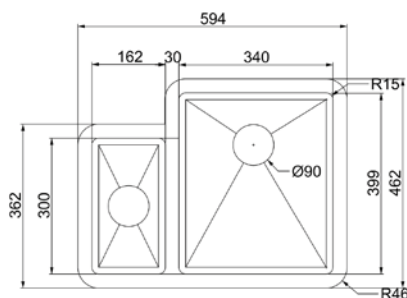

Description

Article no.

inside dimension: 532 x 400 x 220/110 mm
with overflow

PRFE350L

PRFE 350R

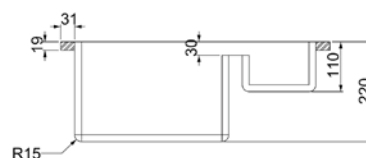
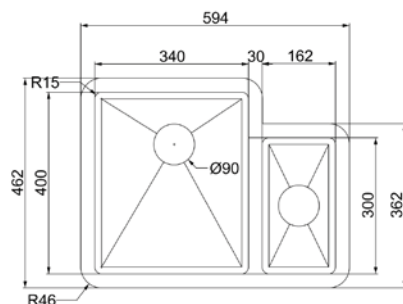

Description

Article no.

inside dimension: 532 x 400 x 220/110 mm
with overflow

PRFE350R

EDGE SINKS® – STAINLESS STEEL SINKS that can be integrated seamlessly



PRFE 400

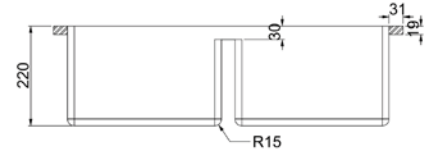
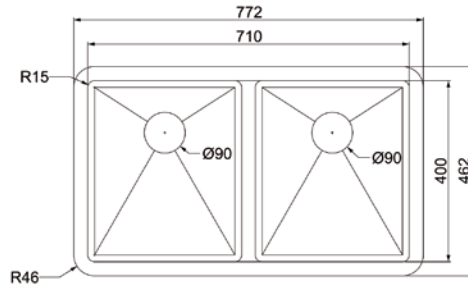

Description

Article no.

inside dimension: 710 x 400 x 220 mm
with overflow

PRFE400

PRFE 500

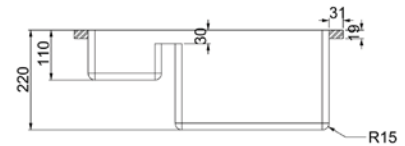
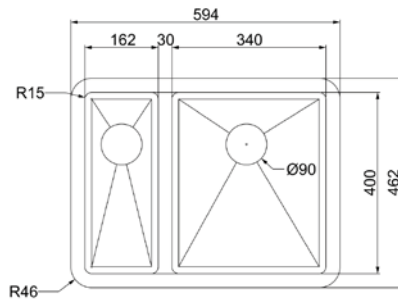

Description

Article no.

inside dimension: 532 x 400 x 220 mm
with overflow

PRFE500

ACCESSORIES EDGE SINKS®

Description

Article no.

COM024

Drain and overflow set (single basin)

COM024

COM025

Drain and overflow set (double basin)

COM025

COM028

Drain and overflow set (for the installation of a PRFE100 in conjunction with another Edge Sinks® basin)

COM028

COM018

Drain and overflow set with twist excenter (single basin)

COM018

COM019

Drain and overflow set with twist excenter (double basin)

COM019



PRODUCT LIST lavanto® 2016

Bowls

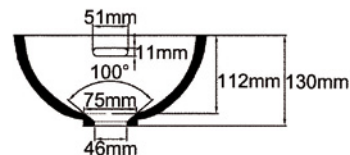
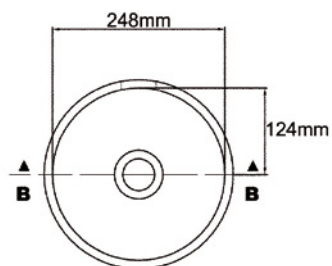

**lavanto® – BOWLS MADE OF SOLID SURFACE MATERIAL****PICCOLO*****Description****Article no.**

with overflow incl. overflow set

LB248-H-0

without overflow

LB248-H-1

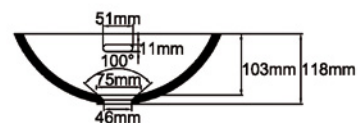
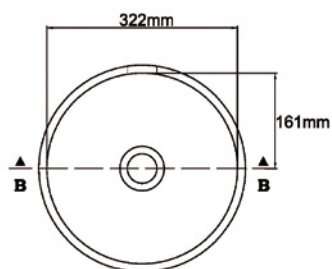
NINO***Description****Article no.**

with overflow incl. overflow set

LB322-H-0

without overflow

LB322-H-1

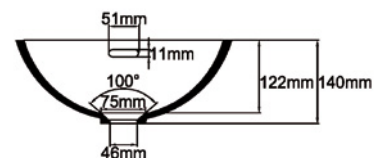
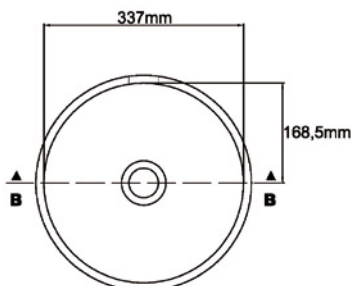
FONTE***Description****Article no.**

with overflow incl. overflow set

LB337-H-0

without overflow

LB337-H-1

* This bowl is available only in a limited colour range!
Compatible drain fittings can be found on page 55 under Accessories.

lavanto® – BOWLS MADE OF SOLID SURFACE MATERIAL

ROTONDO*

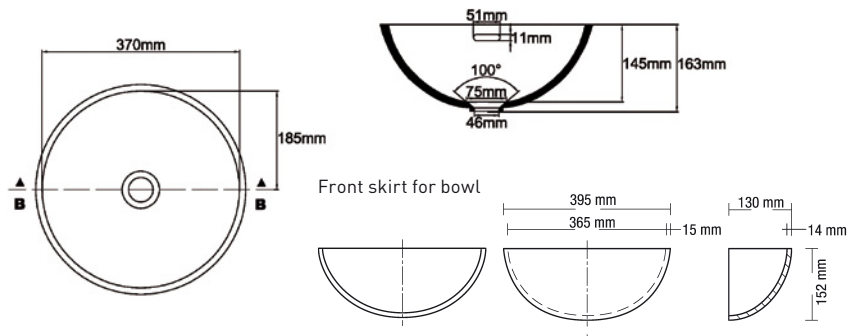

Description	Article no.
with overflow incl. overflow set	LB370-H-0
without overflow	LB370-H-1
Front skirt for bowl	LB370-H-30

TERRA*

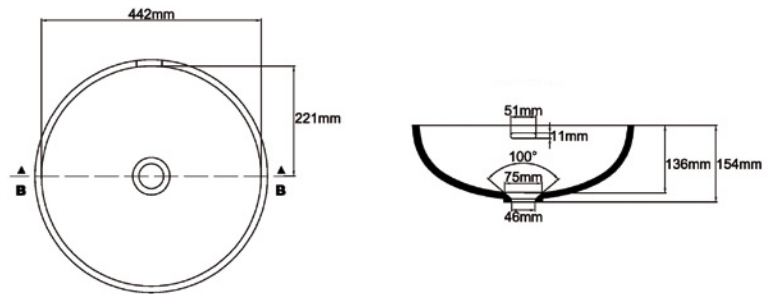

Description	Article no.
with overflow incl. overflow set	LB442-H-0
without overflow	LB442-H-1

COMO*

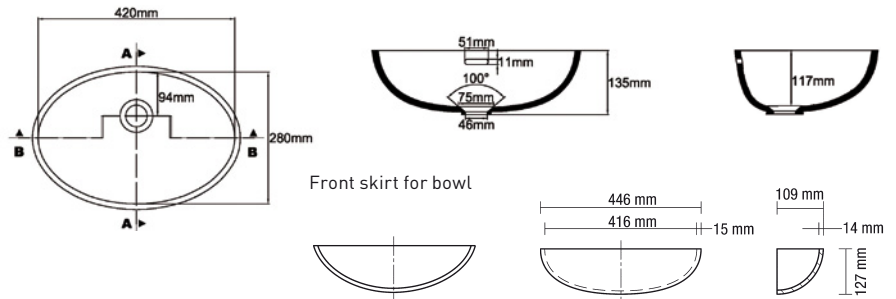

Description	Article no.
with overflow incl. overflow set	LB420-H-0
without overflow	LB420-H-1
Front skirt for bowl	LB420-H-30

* This bowl is available only in a limited colour range!
Compatible drain fittings can be found on page 55 under Accessories.



lavanto® – BOWLS MADE OF SOLID SURFACE MATERIAL

QUANTO*

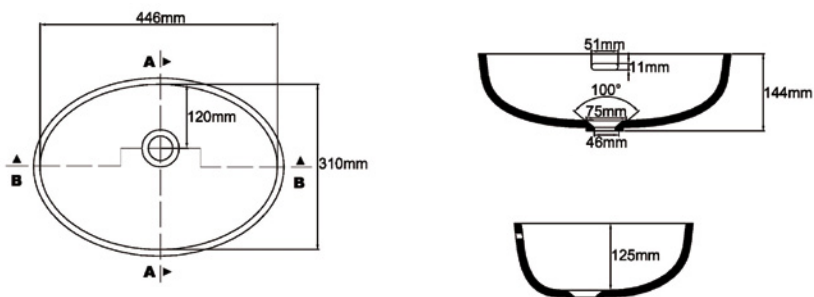

Description

Article no.

with overflow incl. overflow set

LB446-H-0

without overflow

LB446-H-1

UNO*

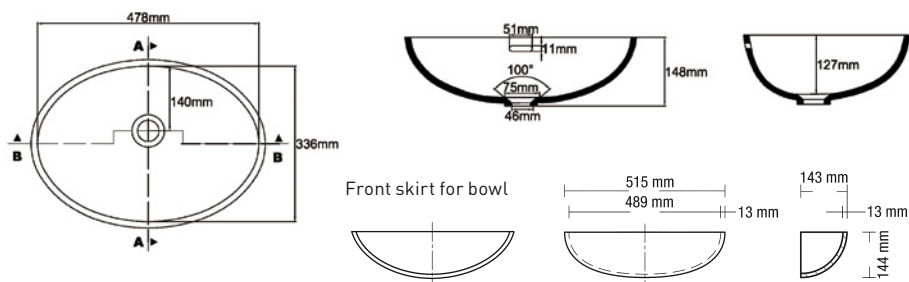

Description

Article no.

with overflow incl. overflow set

LB478-H-0

without overflow

LB478-H-1

Front skirt for bowl

LB478-H-30

GRANDE*

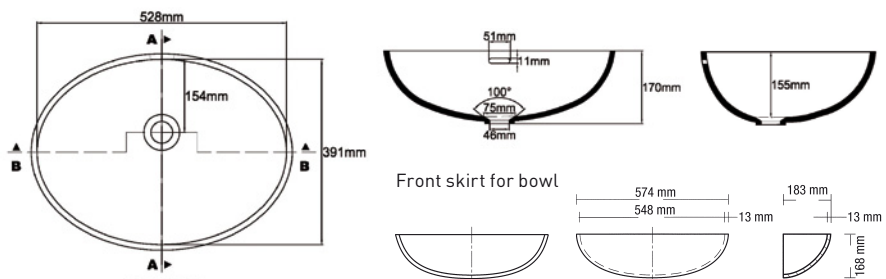

Description

Article no.

with overflow incl. overflow set

LB528-H-0

without overflow

LB528-H-1

Front skirt for bowl

LB528-H-30

* This bowl is available only in a limited colour range!
Compatible drain fittings can be found on page 55 under Accessories.

lavanto® – BOWLS MADE OF SOLID SURFACE MATERIAL

LANDRO*

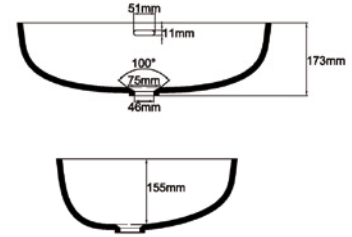
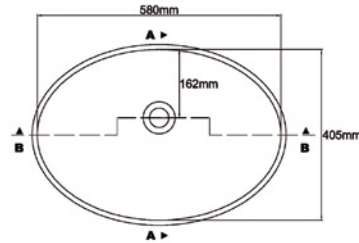

Description

Article no.

with overflow incl. overflow set

LB580-H-0

without overflow

LB580-H-1

VIVO*

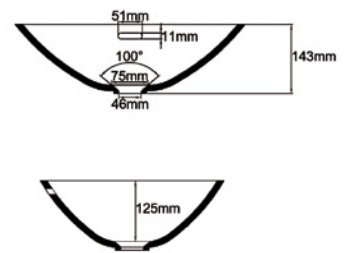
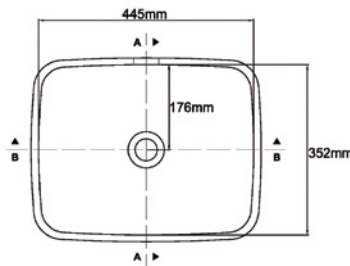

Description

Article no.

with overflow incl. overflow set

LB445-H-0

without overflow

LB445-H-1

VERO*

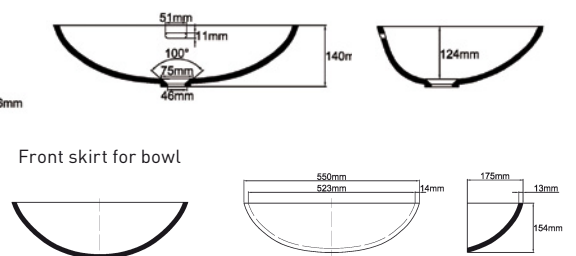
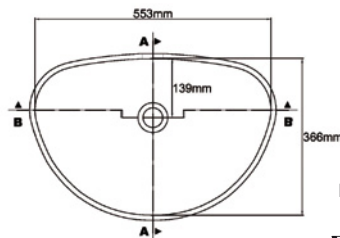

Description

Article no.

with overflow incl. overflow set

LB553-H-0

without overflow

LB553-H-1

Front skirt for bowl

LB553-H-30

* This bowl is available only in a limited colour range!
Compatible drain fittings can be found on page 55 under Accessories.



lavanto® – BOWLS MADE OF SOLID SURFACE MATERIAL

DELTA*

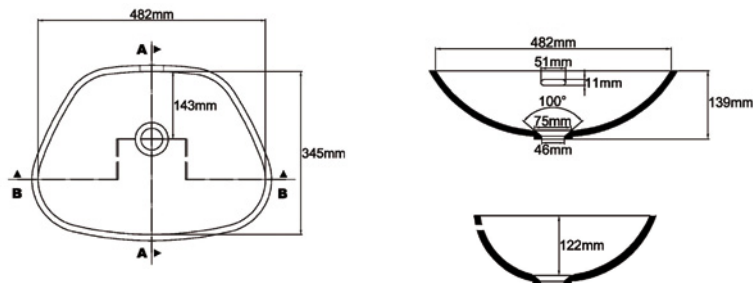

Description

Article no.

with overflow incl. overflow set

LB482-H-0

without overflow

LB482-H-1

ARCO 400-330

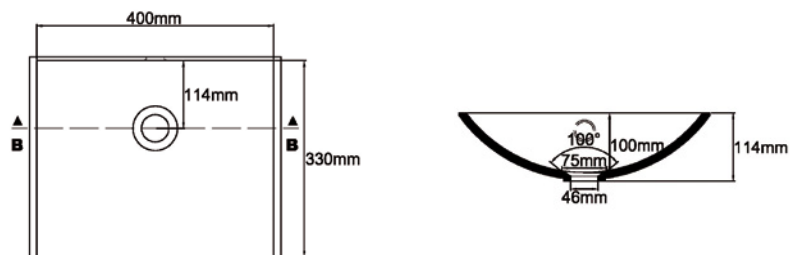

Description

Article no.

with overflow incl. overflow set

LB400-330-H-0

without overflow

LB400-330-H-1

ARCO 500-330

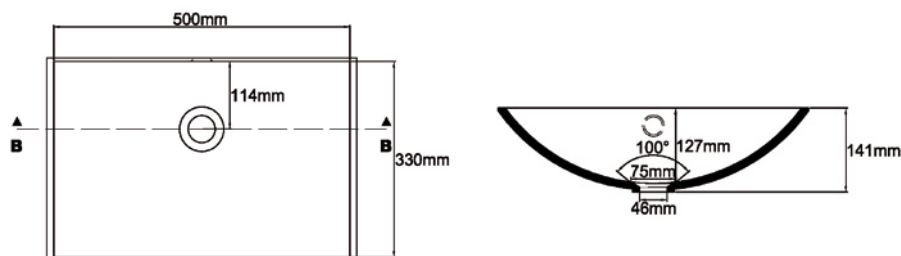

Description

Article no.

with overflow incl. overflow set

LB500-330-H-0

without overflow

LB500-330-H-1

* This bowl is available only in a limited colour range!
Compatible drain fittings can be found on page 55 under Accessories.

lavanto® – BOWLS MADE OF SOLID SURFACE MATERIAL

ARCO 500-370

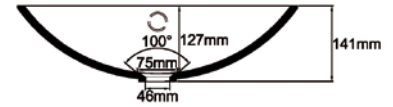
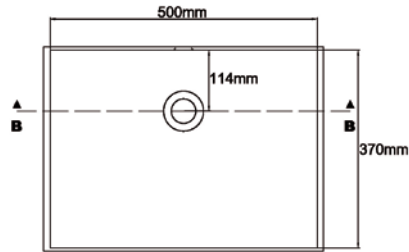

Description

Article no.

with overflow incl. overflow set

LB500-370-H-0

without overflow

LB500-370-H-1

ARCO 580-330

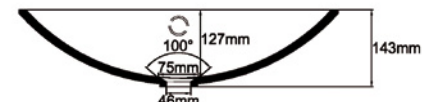
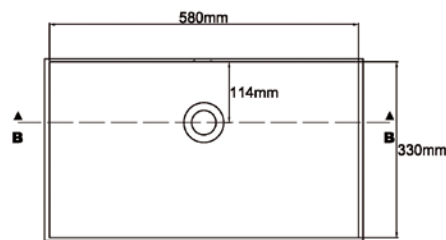

Description

Article no.

with overflow incl. overflow set

LB580-330-H-0

without overflow

LB580-330-H-1

ARCO 580-370

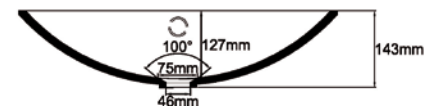
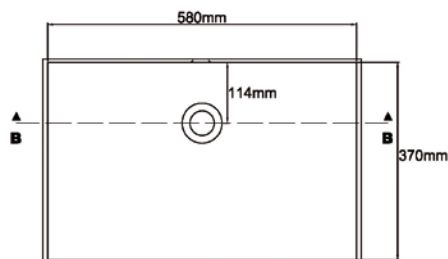

Description

Article no.

with overflow incl. overflow set

LB580-370-H-0

without overflow

LB580-370-H-1

Compatible drain fittings can be found on page 55 under Accessories.



lavanto® – BOWLS MADE OF SOLID SURFACE MATERIAL

ARCO 820-330

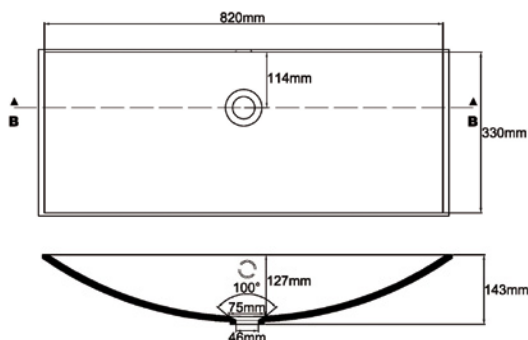

Description

Article no.

with overflow incl. overflow set

LB820-330-H-0

without overflow

LB820-330-H-1

ARCO 820-370

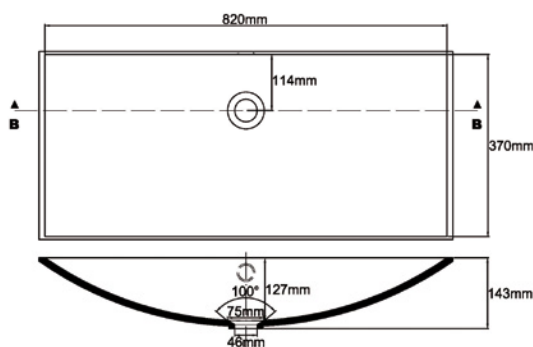

Description

Article no.

with overflow incl. overflow set

LB820-370-H-0

without overflow

LB820-370-H-1

ARCO 1060-330

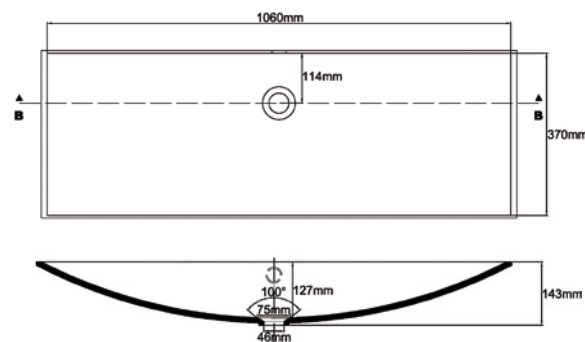

Description

Article no.

with overflow incl. overflow set

LB1060-330-H-0

without overflow

LB1060-330-H-1

Compatible drain fittings can be found on page 55 under Accessories.

lavanto® – BOWLS MADE OF SOLID SURFACE MATERIAL

ARCO 1060-370

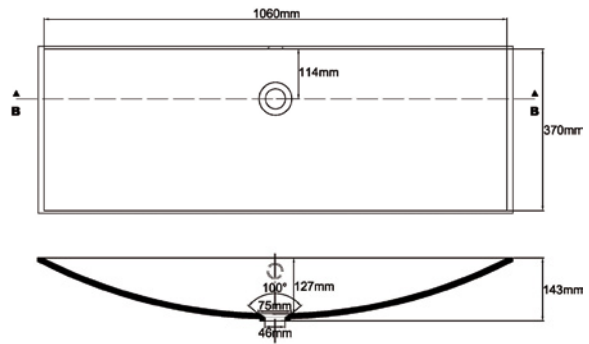

Description

Article no.

with overflow incl. overflow set

LB1060-370-H-0

without overflow

LB1060-370-H-1

FRESCO 450-280*

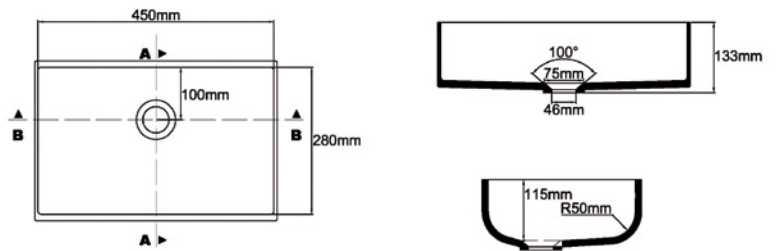

Description

Article no.

with overflow incl. overflow set

LB450-280-H-0

without overflow

LB450-280-H-1

FRESCO 520-330*

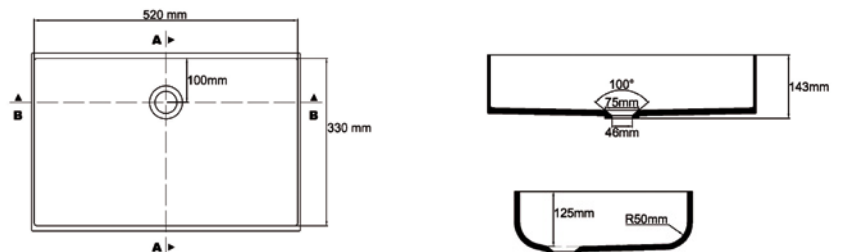

Description

Article no.

with overflow incl. overflow set

LB520-330-H-0

without overflow

LB520-330-H-1

* This bowl is available only in a limited colour range!
Compatible drain fittings can be found on page 55 under Accessories.



lavanto® – BOWLS MADE OF SOLID SURFACE MATERIAL

FRESCO 600-265*

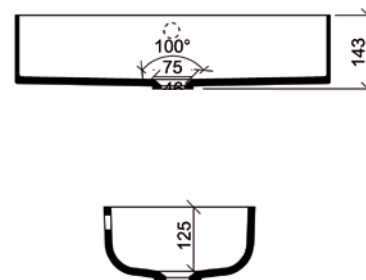
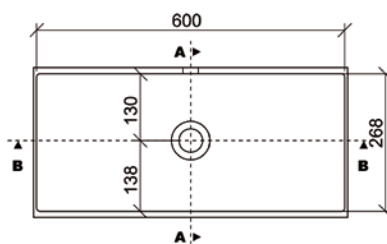

Description

Article no.

with overflow incl. overflow set

LB600-265-H-0

without overflow

LB600-265-H-1

FRESCO 600-320*

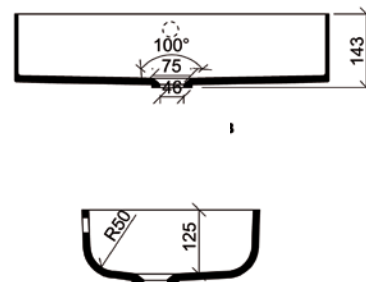
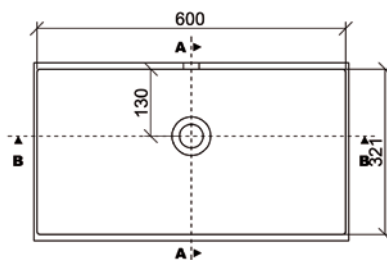

Description

Article no.

with overflow incl. overflow set

LB600-320-H-0

without overflow

LB600-320-H-1

FRESCO 600-370*

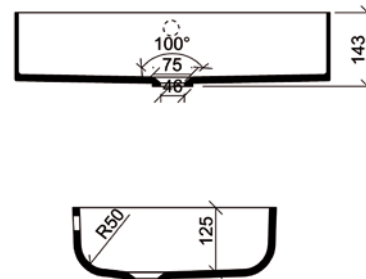
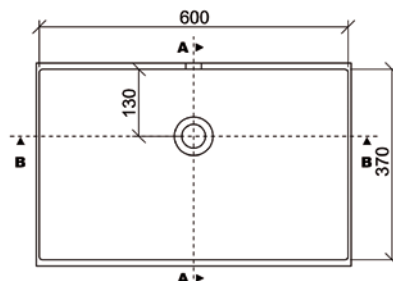

Description

Article no.

with overflow incl. overflow set

LB600-370-H-0

without overflow

LB600-370-H-1

* This bowl is available only in a limited colour range!
Compatible drain fittings can be found on page 55 under Accessories.

lavanto® – BOWLS MADE OF SOLID SURFACE MATERIAL

AVERNO 400-280

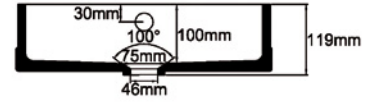
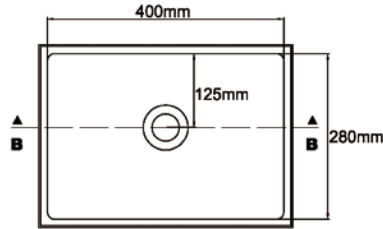

Description

Article no.

with overflow incl. overflow set

LBR400-280-H-0

without overflow

LBR400-280-H-1

TENNO 500-320

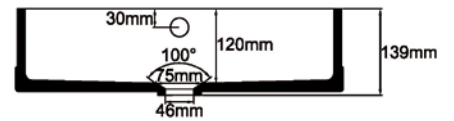
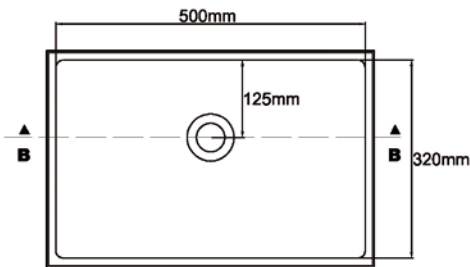

Description

Article no.

with overflow incl. overflow set

LBR500-320-H-0

without overflow

LBR500-320-H-1

Compatible drain fittings can be found on page 55 under Accessories.



lavanto® – BOWLS MADE OF SOLID SURFACE MATERIAL

BARREA 600-370

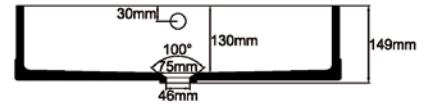
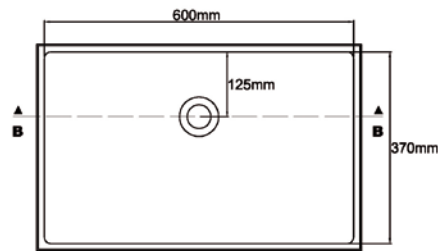

Description

Article no.

with overflow incl. overflow set

LBR600-370-H-0

without overflow

LBR600-370-H-1

BARREA 800-370

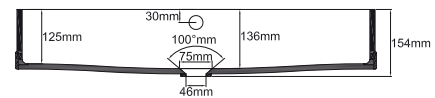
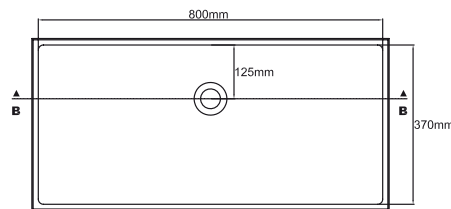

Description

Article no.

with overflow incl. overflow set

LBR800-370-H-0

without overflow

LBR800-370-H-1

BARREA 1100-370

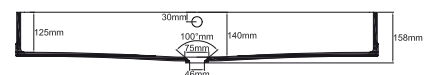
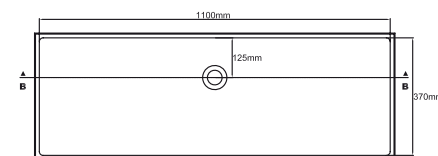

Description

Article no.

with overflow incl. overflow set

LBR1100-370-H-0

without overflow

LBR1100-370-H-0

Compatible drain fittings can be found on page 55 under Accessories.

lavanto® – BOWLS MADE OF SOLID SURFACE MATERIAL

SCINDO 600-400

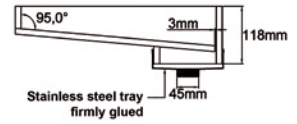
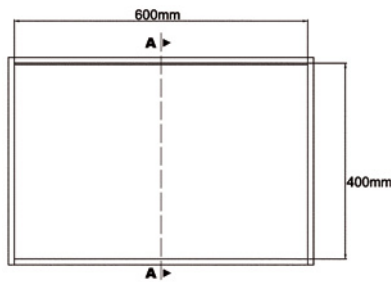

Description

Article no.

Slot drain with stainless steel trough firmly glued, without overflow

LB600-400S-H-1

SCINDO 400-400

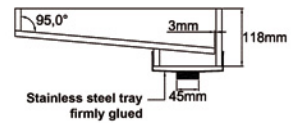
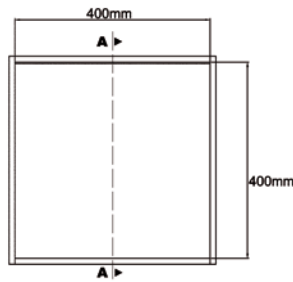

Description

Article no.

Slot drain with stainless steel trough firmly glued, without overflow

LB400-400S-H-1

Compatible drain fittings can be found on page 55 under Accessories.

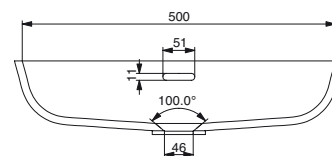
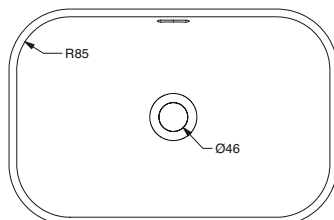

lavanto® – BOWLS MADE OF SOLID SURFACE MATERIAL

LOMO 500-320***Description****Article no.**

with overflow incl. overflow set

LB500-320-A-0

without overflow

LB500-320-A-1

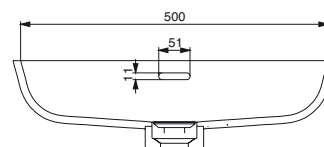
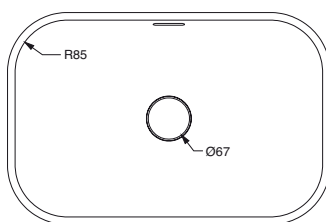
LOMO PUSH-PUSH 500-320*includes drain made of solid surface material
with push-push-automatic**Description****Article no.**

with overflow incl. overflow set

LBP500-320-A-0

without overflow, with permanent drain valve

LBP500-320-A-1

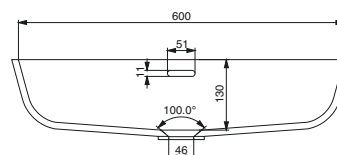
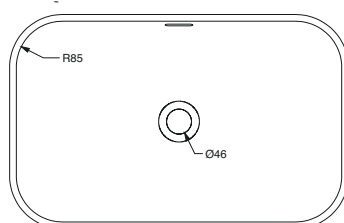
LOMO 600-370***Description****Article no.**

with overflow incl. overflow set

LB600-370-A-0

without overflow

LB600-370-A-1

* This bowl is available only in a limited colour range!
Compatible drain fittings can be found on page 55 under Accessories.

lavanto® – BOWLS MADE OF SOLID SURFACE MATERIAL

LOMO PUSH-PUSH 600-370*

includes drain made of solid surface material with push-push-automatic

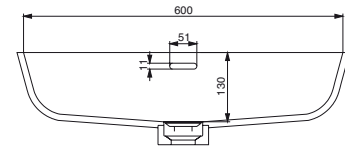
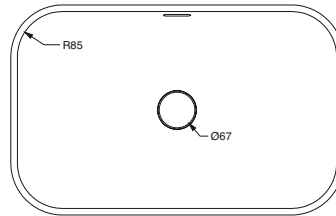

Description

Article no.

with overflow incl. overflow set

LBP600-370-A-0

without overflow, with permanent drain valve

LBP600-370-A-1

LOMO 800-370*

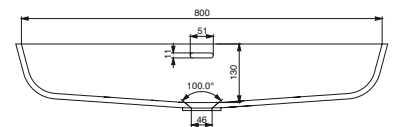
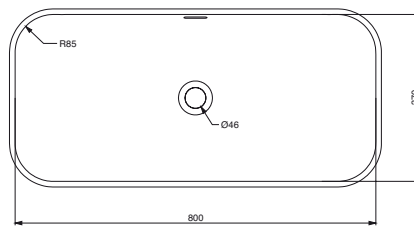

Description

Article no.

with overflow incl. overflow set

LB800-370-A-0

without overflow

LB800-370-A-1

LOMO PUSH-PUSH 800-370*

includes drain made of solid surface material with push-push-automatic

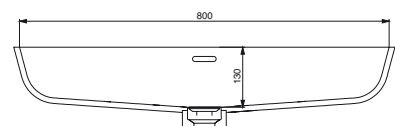
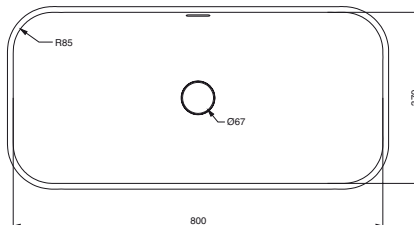

Description

Article no.

with overflow incl. overflow set

LBP800-370-A-0

without overflow, with permanent drain valve

LBP800-370-A-1

* This bowl is available only in a limited colour range!
Compatible drain fittings can be found on page 55 under Accessories.



lavanto® – BOWLS MADE OF SOLID SURFACE MATERIAL

CINELLO 400-270*



Nur in Verbindung mit einem Permanentablauf

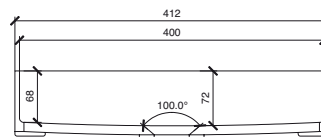
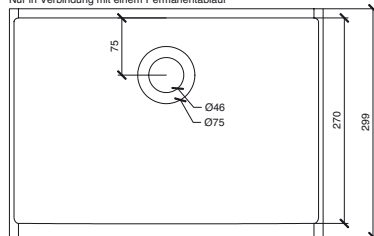

Description

Article no.

without overflow

LB400-270-A-0

CINELLO 500-340*

basic module

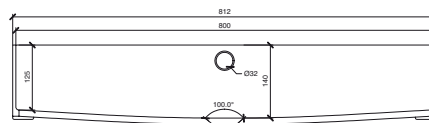
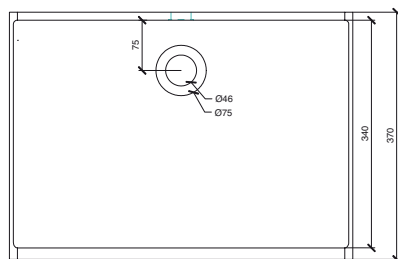

Description

Article no.

with overflow incl. overflow set

LB500-340-A-0

without overflow

LB500-340-A-1

CINELLO EXTENSION*

up to 800 mm

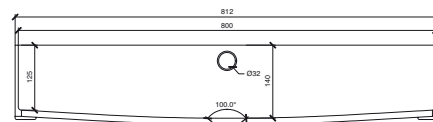
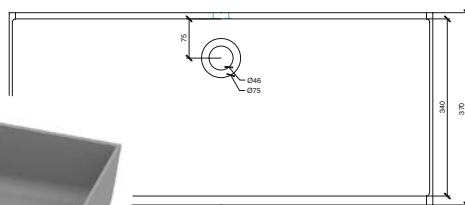

Description

Article no.

Any desired width up to 800 mm is possible. An additional charge will be simply calculated independent of the selected width.

LB500-340-A-0-
AUFPREIS

* This bowl is available only in a limited colour range!
Compatible drain fittings can be found on page 55 under Accessories.

lavanto® – CAST BOWLS MADE OF SOLID SURFACE MATERIAL

BRENTA*

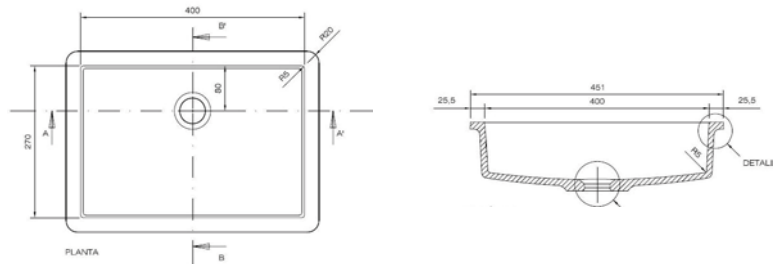

Description

Article no.

with overflow

LB400-270A-0

ARNO*

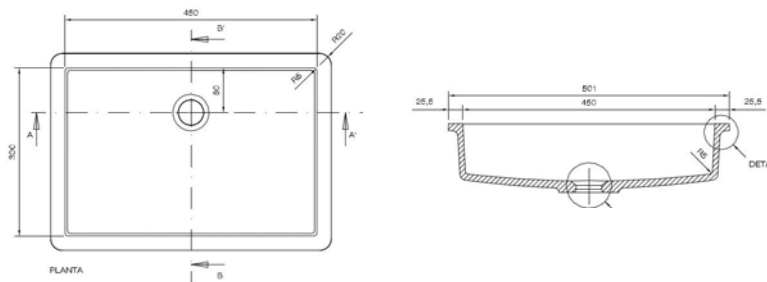

Description

Article no.

with overflow

LB450-300A-0

TANARO*

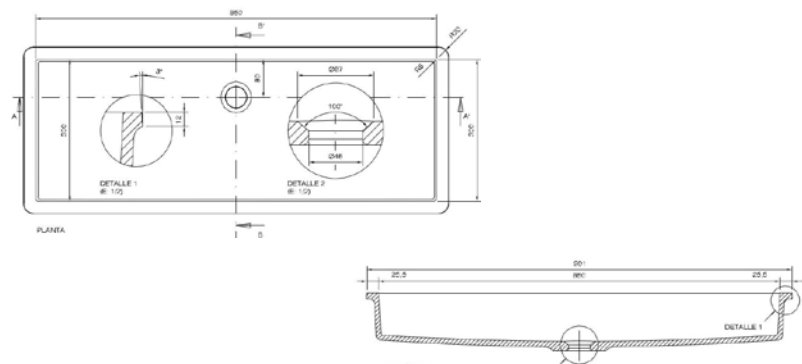

Description

Article no.

with overflow

LB850-300A-0

* This bowl is available only in colour F1-8256 Polaris!
Compatible drain fittings can be found on page 55 under Accessories.



lavanto® – TOP-MOUNT BASINS WITH PEDESTAL

AVERNO 400-280*

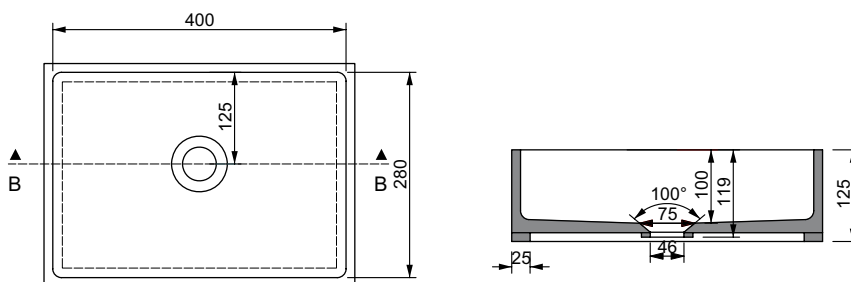
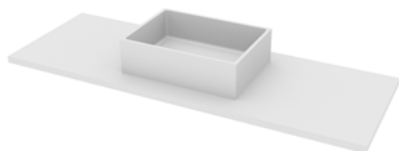

Description

Article no.

Top-mount basin with pedestal (delivery without base plate and without overflow cut-out)

LBR400-280-A-H-1

BARREA 600-370*

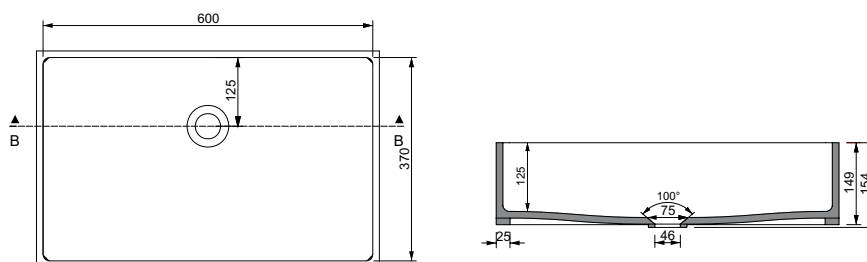

Description

Article no.

Top-mount basin with pedestal (delivery without base plate and without overflow cut-out)

LBR600-370-A-H-1

BARREA 800-370*

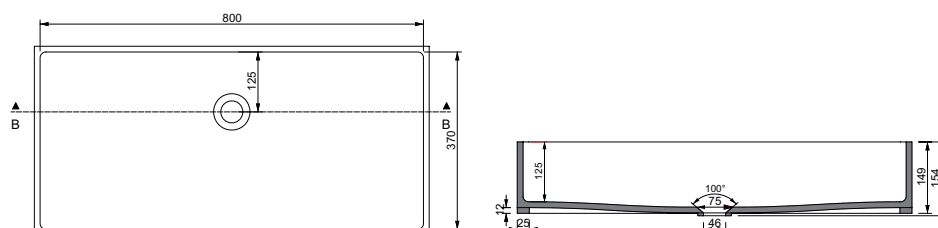

Description

Article no.

Top-mount basin with pedestal (delivery without base plate and without overflow cut-out)

LBR800-370-A-H-1

* All top-mount basins are available in the colours F1-8256 Polaris, F1-8026 Super White and F1-8090 Snowfall. Compatible drain fittings can be found on page 55 under Accessories.

lavanto® - TOP-MOUNT BASINS WITH PEDESTAL

BARREA 1100-370*

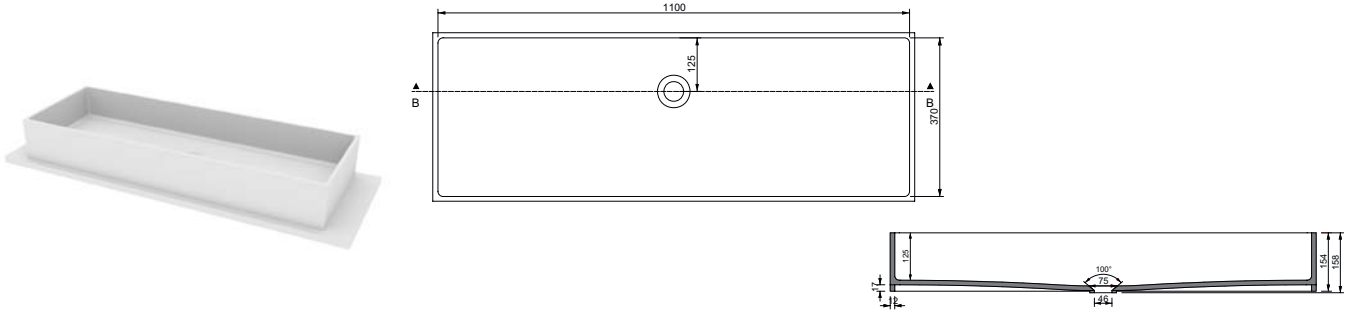

Description

Article no.

Top-mount basin with pedestal (delivery without base plate and without overflow cut-out)

LBR1100-370-A-H-1

NINO 332*

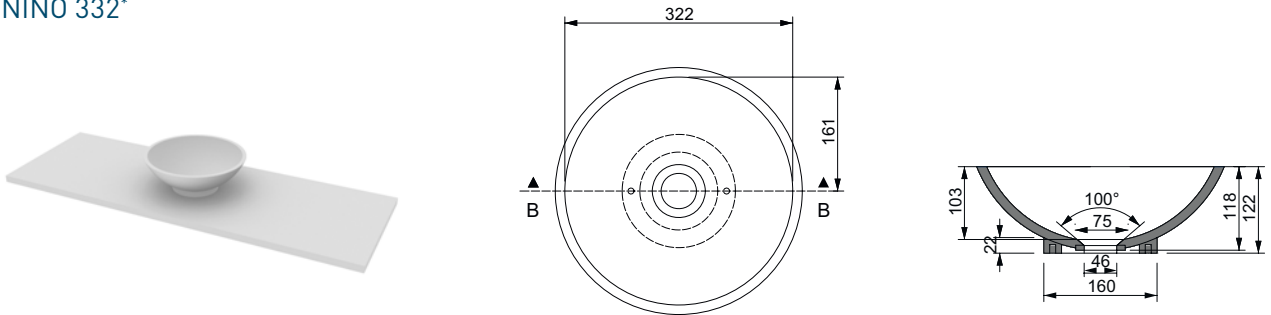

Description

Article no.

Top-mount basin with pedestal (delivery without base plate and without overflow cut-out)

LB322-A-H-1

TENNO 500-320*

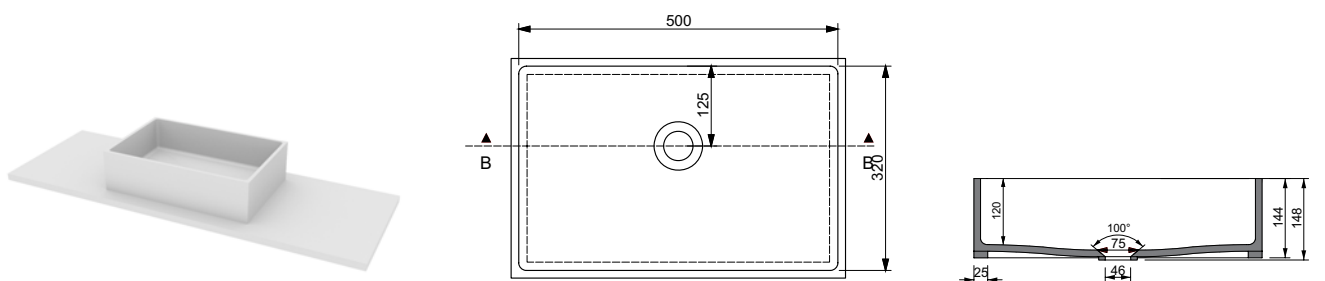

Description

Article no.

Top-mount basin with pedestal (delivery without base plate and without overflow cut-out)

LBR500-320-A-H-1

* All top-mount basins are available in the colours F1-8256 Polaris, F1-8026 Super White and F1-8090 Snowfall. Compatible drain fittings can be found on page 55 under Accessories.



lavanto® – TOP-MOUNT BASINS WITH PEDESTAL

TERRA 442*

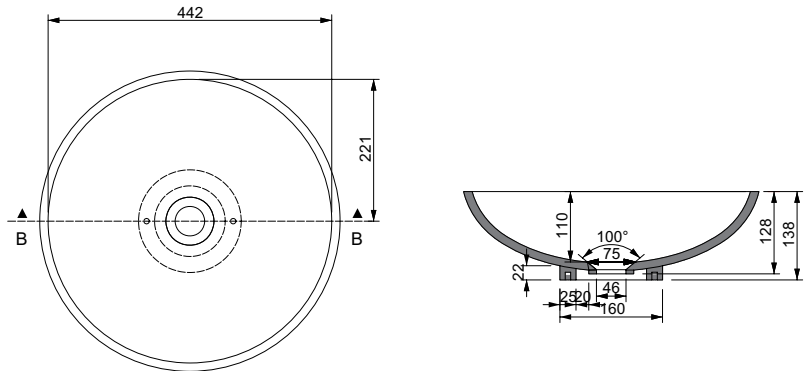

Description

Article no.

Top-mount basin with pedestal (delivery without base plate and without overflow cut-out)

LB442-A-H-1

VIVO 445*

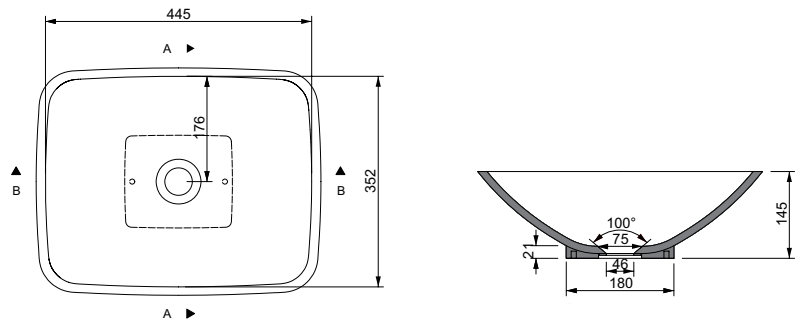

Description

Article no.

Top-mount basin with pedestal (delivery without base plate and without overflow cut-out)

LB445-A-H-1

* All top-mount basins are available in the colours F1-8256 Polaris, F1-8026 Super White and F1-8090 Snowfall. Compatible drain fittings can be found on page 55 under Accessories.





PRODUCT LIST lavanto® 2016

Medical Basins and Tubs



lavanto® – MEDICAL BASINS AND TUBS

MADE OF SOLID SURFACE MATERIAL

NEMI*

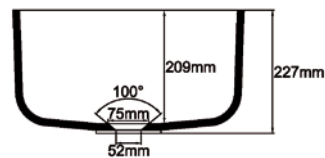
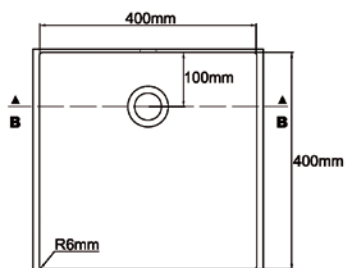

Description

Article no.

without overflow

LB400-H-1

MEDICO*

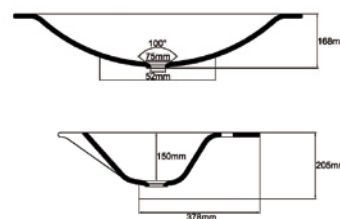
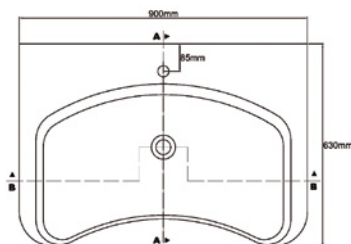

Medico is also available in the size 900 x 524 mm without armature hole cut-out

Description

Article no.

without overflow with special console

LB900-H-1

* This bowl is available only in a limited colour range!

lavanto® – MEDICAL BASINS AND TUBS MADE OF SOLID SURFACE MATERIAL

BAMBINO A*

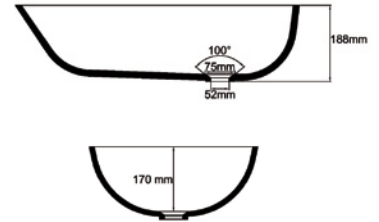
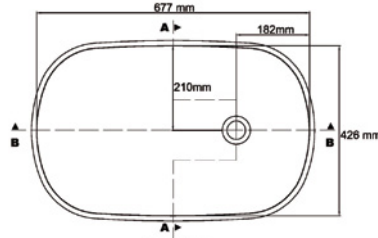

Description

Article no.

without overflow

LB677-H-1

BAMBINO B*

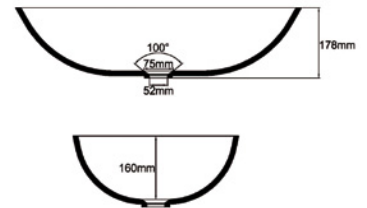
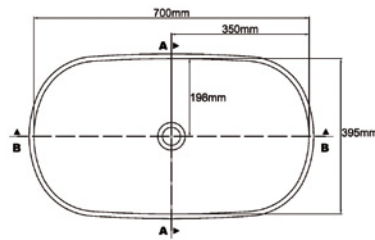

Description

Article no.

without overflow

LB700-H-1

BAMBINO C*

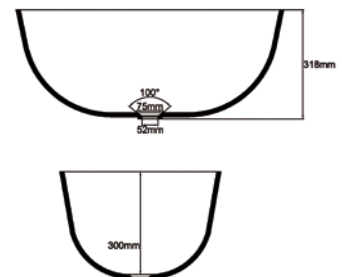
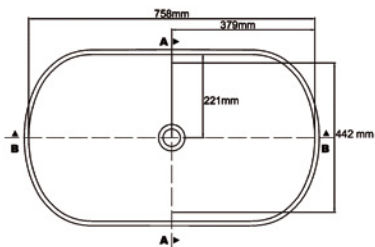

Description

Article no.

without overflow

LB758-H-1

* This bowl is available only in a limited colour range!



PRODUCT LIST lavanto® 2016

Shower Trays





lavanto® – SHOWER TRAYS MADE OF SOLID SURFACE MATERIAL

DOCCA 800-800

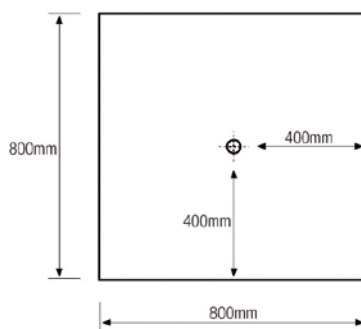

Description

Article no.

LST800-800-H

Frame extension up to 895 x 895

LST800-800S-H

DOCCA 900-900

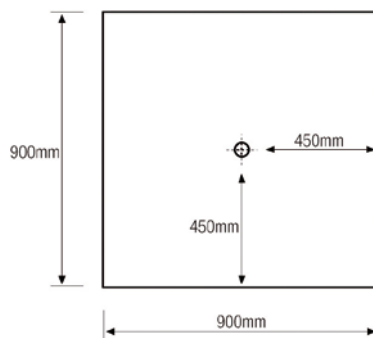

Description

Article no.

LST900-900-H

Frame extension up to 995 x 995

LST900-900S-H

DOCCA 1000-1000

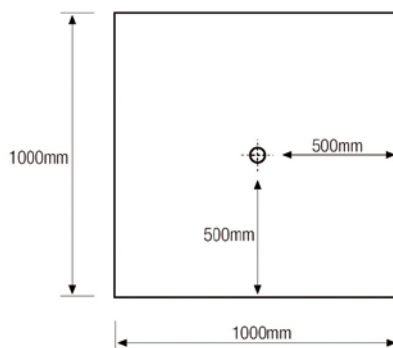

Description

Article no.

LST1000-1000-H

Frame extension up to 1095 x 1095

LST1000-1000S-H

The shower trays made of the solid surface material Avonite® are available in a material thickness of 9 mm. They can be delivered in the colours F1-8256 Polaris and F1-8026 Super White. By request, the DOCCA series can be fabricated in the Avonite® colours that are only available in a thickness of 12 mm.

lavanto® – SHOWER TRAYS MADE OF SOLID SURFACE MATERIAL

DOCCA 1000-800

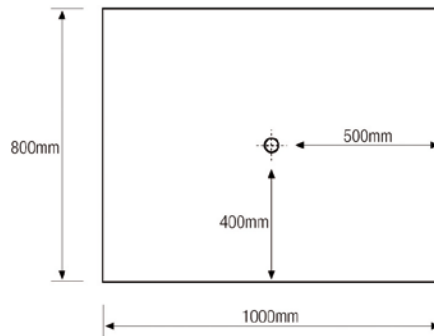

Description

Article no.

LST1000-800-H

Frame extension up to 1095 x 895

LST1000-800S-H

DOCCA 1200-1200

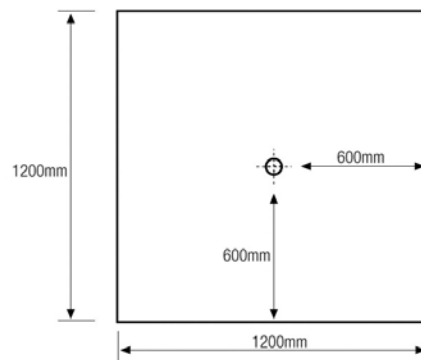

Description

Article no.

LST1200-1200-H

Frame extension up to 1295 x 1295

LST1200-1200S-H

The shower trays made of the solid surface material Avonite® are available in a material thickness of 9 mm. They can be delivered in the colours F1-8256 Polaris and F1-8026 Super White. By request, the DOCCA series can be fabricated in the Avonite® colours that are only available in a thickness of 12 mm.

The perfect system installation

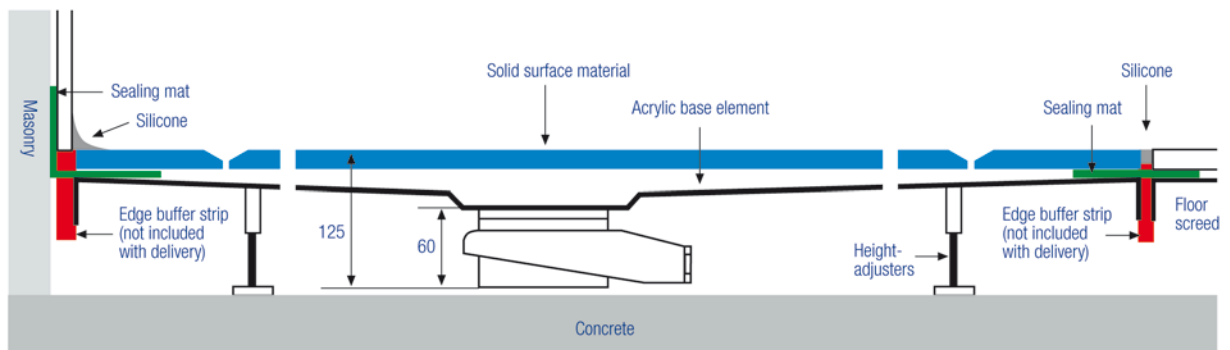



PRODUCT LIST lavanto® 2016
Accessories



ACCESSORIES SINKS & BOWLS

Product	Article no.
Geberit Clou Drain and overflow valve	LZ11
Drain system H1 with manual control for lavanto® Sinks	LZ-AH1
Drain system D1 with pop-up waste set for lavanto® Sinks	LZ-AD1
Drain fitting is 1 1/4" with sieve cover	LZ25-1
COM024 Drain and overflow set for Edge Sinks® Basins (single basin)	COM024
COM025 Drain and overflow set for Edge Sinks® Basins (double basin)	COM025
COM028 Drain and overflow set for Edge Sinks® Basins (for the installation of a PRFE100 in conjunction with another Edge Sinks® Basin)	COM028
COM018 Drain and overflow set with twist excenter (single basin)	COM018
COM019 Drain and overflow set with twist excenter (double basin)	COM019
Template set for undermount installation (cutout and groove)	LZ123-20

ACCESSORIES SHOWER TRAYS

Insulating tape	LSTDB
Height adjuster plus	LSTFH
Clamp strip for bathtub frame	LSTWRKS

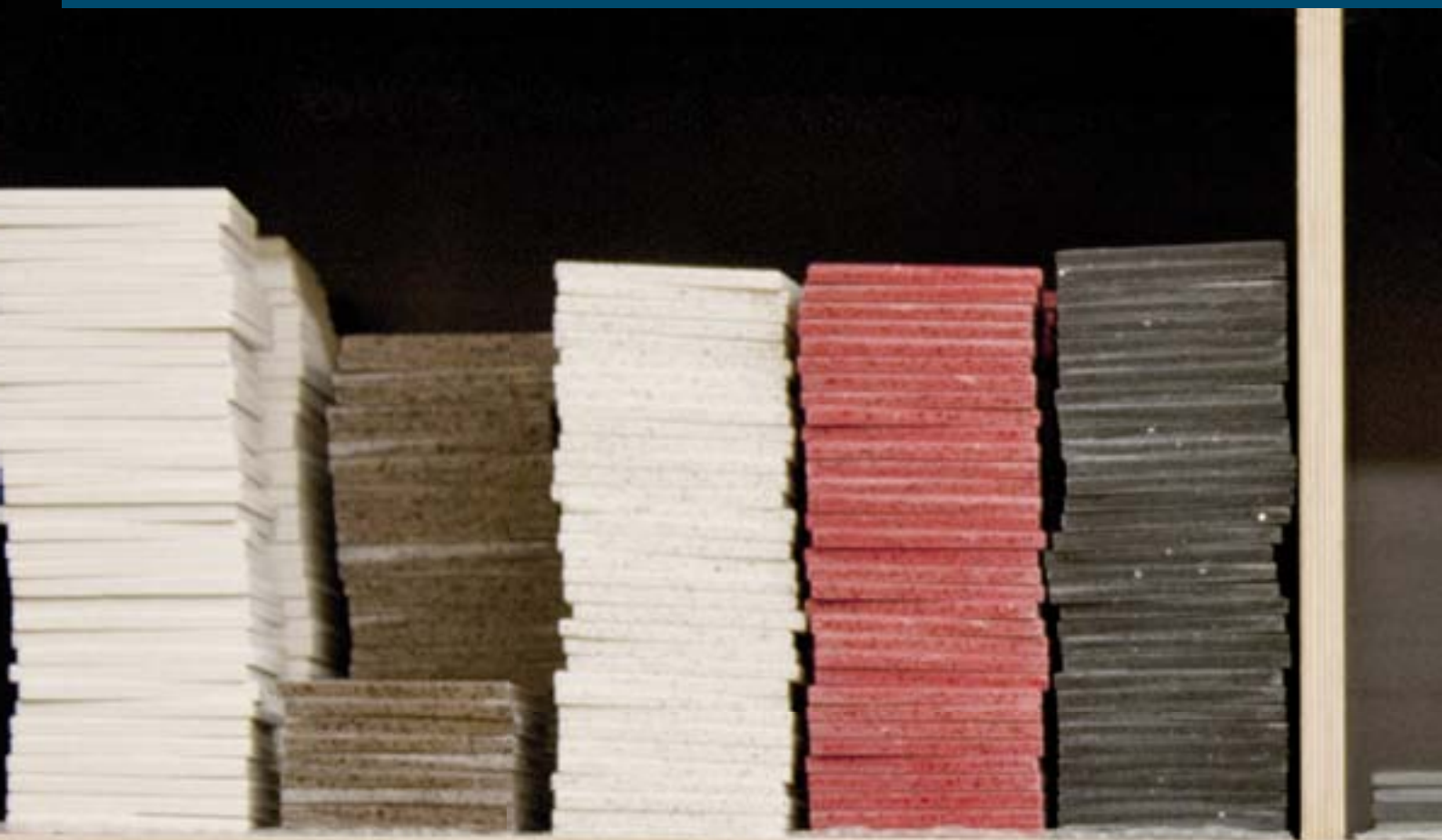

PRODUCT LIST lavanto® 2016

Colour Chart







Solid Surface Material – AVONITE®

SOLIDS



F1-8256 **Polaris**
12/9/6 mm



F1-8026 **Super White**
12/9/6/3 mm



F1-8090 **Snowfall**
12/3 mm



F1-8066 **Porcelain**
12 mm



F1-8064 **Ice White***
12 mm

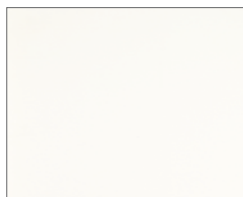

F1-8106 **Ivory**
12 mm

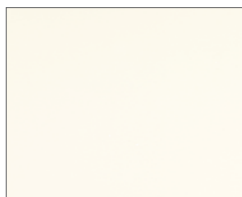

F1-8024 **Crème**
12 mm

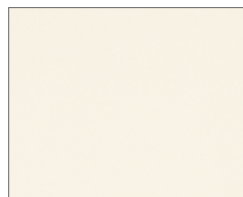

F1-8010 **Bone**
12 mm

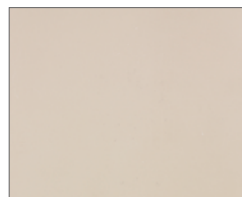

F1-8286 **Cardamom***
12 mm

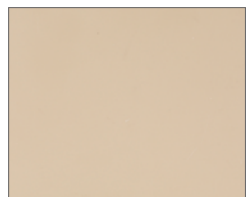

F1-8272 **Café au Lait***
12 mm

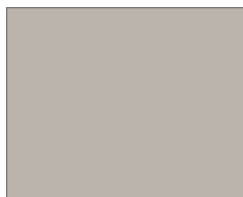

F1-8278 **Clay***
12 mm

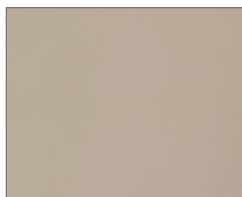

F1-8288 **Putty***
12 mm

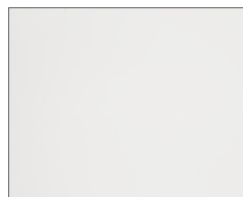

F1-8292 **Cloud***
12 mm

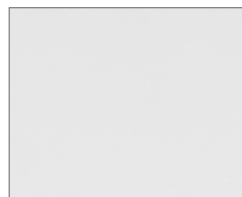

F1-8290 **Plumbic***
12 mm

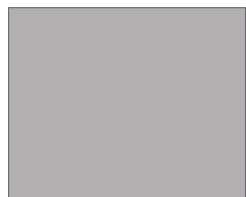

F1-8276 **Brume***
12 mm



F1-8280 **Smoke***
12 mm

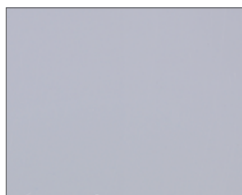

F1-8260 **Rain***
12 mm

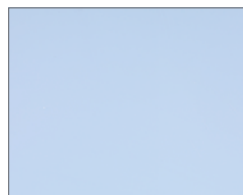

F1-8258 **Antique Blue***
12 mm

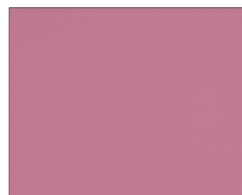

F1-8262 **Vino***
12 mm

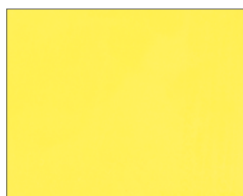

F1-8268 **Mango***
12 mm



F1-8254 **Green Apple***
12 mm



F1-8252 **Orange Zest***
12 mm



F1-8264 **Crimson***
12 mm



F1-8284 **Azul***
12 mm



F1-8274 **Sugar Cane***
12 mm



F1-8266 **Fondant***
12 mm



F1-8282 **Carbon***
12 mm



F1-8240 **Eclipse***
12 mm

Solid Surface Material – AVONITE®

STRUCTURED

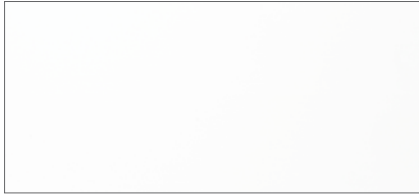

F1-8206 **Alpine Shimmer**
12 mm



F1-9065 **Artica**
12 mm



F1-7810 **Malt**
12 mm

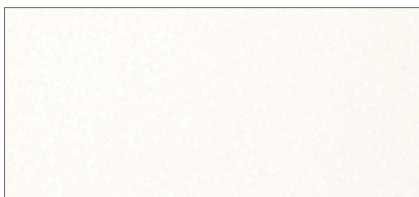

F1-9117 **Kokoura**
12 mm

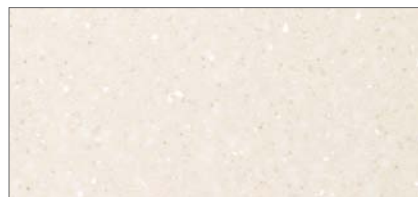

F1-9137 **Casablanca**
12 mm

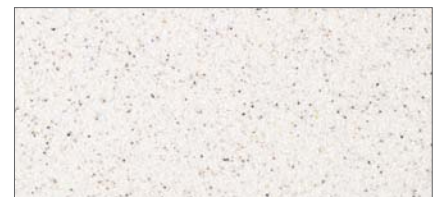

F1-9105 **Aspen**
12 mm



F1-9010 **Stormy Gray**
12 mm

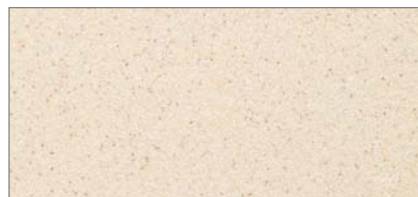

F1-9036 **Sandstorm**
12 mm



F1-9037 **High Desert**
12 mm

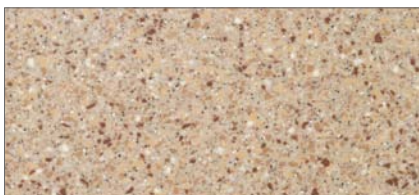

F1-9144 **Palermo**
12 mm



F1-7830 **Bronze***
12 mm



F1-7826 **Signal***
12 mm

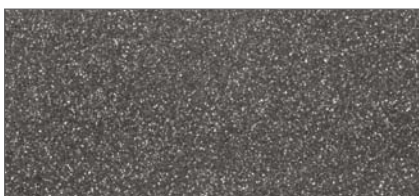

F1-9020 **Black Lava**
12 mm

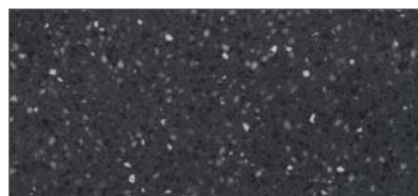

F1-9125 **Black Coral**
12 mm



F1-7820 **Star Shine**
12 mm

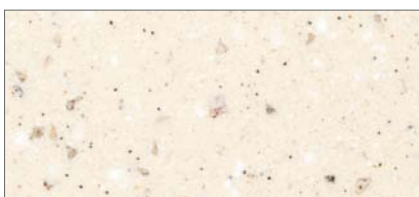

F1-7711 **Jurassic**
12 mm



F1-7921 **Boardwalk**
12 mm



F1-7735 **Dark Roast**
12 mm

Colour Chart



Solid Surface Material – AVONITE®

STRUCTURED

AVONITE®
Acrylic Solid Surface

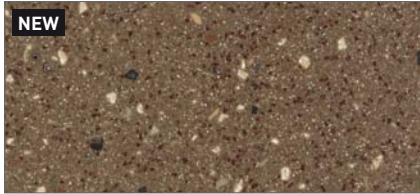

F1-7931 **Cliffside**
12 mm



F1-7555 **Icecap**
12 mm



F1-7502 **Avalanche**
12 mm



F1-7501 **Moon Crystal**
12 mm



F1-7503 **Morning Tundra**
12 mm



F1-7557 **Hazelnut**
12 mm

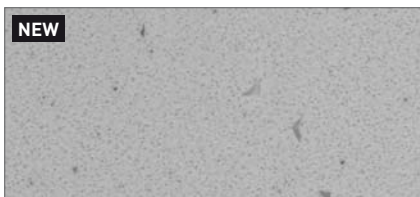

F1-7556 **Shark Skin**
12 mm

STUDIO COLLECTION

STUDIO COLLECTION®
Specialty Blend Solid Surface



K3-8587 **Terra**
12 mm



K3-8586 **Luna**
12 mm



K3-8345 **Silver Pearl**
12 mm



K3-8344 **Charcoal Pearl**
12 mm



K3-8346 **Celestial Pearl**
12 mm

Solid Surface Material – AVONITE®

STUDIO COLLECTION

STUDIO COLLECTION®
Specialty Blend Solid Surface



K3-8480 **Frosted Glass**
12 mm



K3-8455 **Antique Glass**
12 mm



K3-8465 **Sky Glass**
12 mm



K3-8560 **Amber Glass**
12 mm



K3-8420 **Ruby Glass**
12 mm



K3-8603 **Cirrus**
12 mm



K3-8600 **Sirocco**
12 mm



K3-8601 **Neptune**
12 mm



K3-8605 **Bluebell**
12 mm



K3-8606 **Irish Bell**
12 mm



K3-8607 **Red Currant**
12 mm

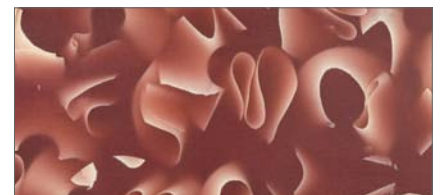

K3-8604 **Rosehip**
12 mm

Notes:

Collection

All colours are available in the specified thicknesses. **The Roskopf + Partner Collection** is particularly tuned to the requirements of our customers. These articles are specially marked (**colour name**) in our overview. These colours are always available in stock so that we can provide you improved production and delivery times.

Dark and matte colours show dust and dirt more easily than light and textured colours. Therefore they require more frequent cleaning.

* These colours are more sensitive to scratches. We recommend against using these colours for heavily used surfaces.

Sheet Material Dimensions

Raw sheet material is available in the following thicknesses and dimensions:

Snowfall/Super White:	3 mm thickness – 2464 x 1245 mm
Polaris/Super White:	6 mm thickness – 3658 x 1370 mm
	9 mm thickness – 3658 x 762 mm
	12 mm thickness – 3658 x 762/1370 mm
Ice White:	12 mm thickness – 3658 x 1370 mm
Remaining Solids/Structured:	12 mm thickness – 3658 x 762 mm
Studio Collection:	12 mm thickness – 3048 x 914 mm

In addition to the specified sheet dimensions, all colour groups can be manufactured in custom sizes. Here you have the option of ordering any sheet thickness from 3-19 mm and panel dimensions from 762 mm to 1524 mm in width and 1829 mm to 5182 mm in length. For details about special sizes, please contact your personal representative regarding delivery times and minimum quantities.



PRODUCT LIST lavanto® 2016

General Information





Delivery Conditions

DELIVERY TIMES AND CONDITIONS FOR

FORM PARTS MADE OF SOLID SURFACE MATERIAL

The production of lavanto® Form Parts commences upon receipt of orders; the shipment to be made within 3-10 business days.

Publication of this list supersedes and renders all previous Product Lists invalid. We reserve the right to correct errors and make technical amendments.

Our terms and conditions apply. You can view these on the Internet under www.rosskopf-partner.com/agb

Warranty – lavanto®

Limited Warranty

Based on the following conditions and for a period of two years, Rosskopf + Partner AG guarantees that all lavanto® products are free of defects in material and workmanship.

Warranty Conditions

The buyer is responsible for checking all goods for defects upon receipt without delay and, in any case, before further processing or assembly. Any defects are to be reported immediately. Any claims in connection with further processing or assembly procedures by the buyer or for any additional obvious defects that are not reported within 14 days of delivery cannot be considered or accepted. Defective products will be replaced immediately.

Warranty claims received by us after processing and assembly may possibly be for other causes and then attributed to lavanto® products. Additional processing and/or assembly costs, replacement costs or other costs incurred are not included in this warranty and will not be considered.

Damage caused by improper use or maintenance, in particular by ignoring the instructions for care and use of lavanto® products, is not covered by the warranty.

Instructions for Use – lavanto®

With lavanto® you have purchased a state-of-the-art product from Rosskopf + Partner. Our lavanto® series products are made of quality materials such as solid surface material; they are very easy to maintain and extremely durable.

Instructions

In order for you to permanently enjoy the products from our company, please follow these instructions:

- When you pour boiling or hot liquids into a lavanto® product, please run cold water into it at the same time.
- Do not place hot pots and pans unprotected onto the surface.
- If your lavanto® product comes into contact with bleach, please do not allow it to remain longer than 5 minutes on the surface. After removing it, we recommend that you clean the surface with general purpose cleaner and then rinse it thoroughly with clean water.
- Do not use harsh chemicals on your lavanto® product and do not forcefully attempt to remove dirt or stains from the surface.
- Rinse the surface immediately with clean water when strong staining liquids (for example, coffee, tea, red wine, etc.) or corrosive chemicals (such as acids, disinfectants with high-percentage ethanol content or colouring/hair dye) come into contact with the product.
- Prevent fire (such as burning cigarettes) from contacting your lavanto® product.
- Please understand that Rosskopf + Partner AG cannot assume responsibility in the warranty for damages caused by not observing these instructions.

For more information, see www.roskopf-partner.com

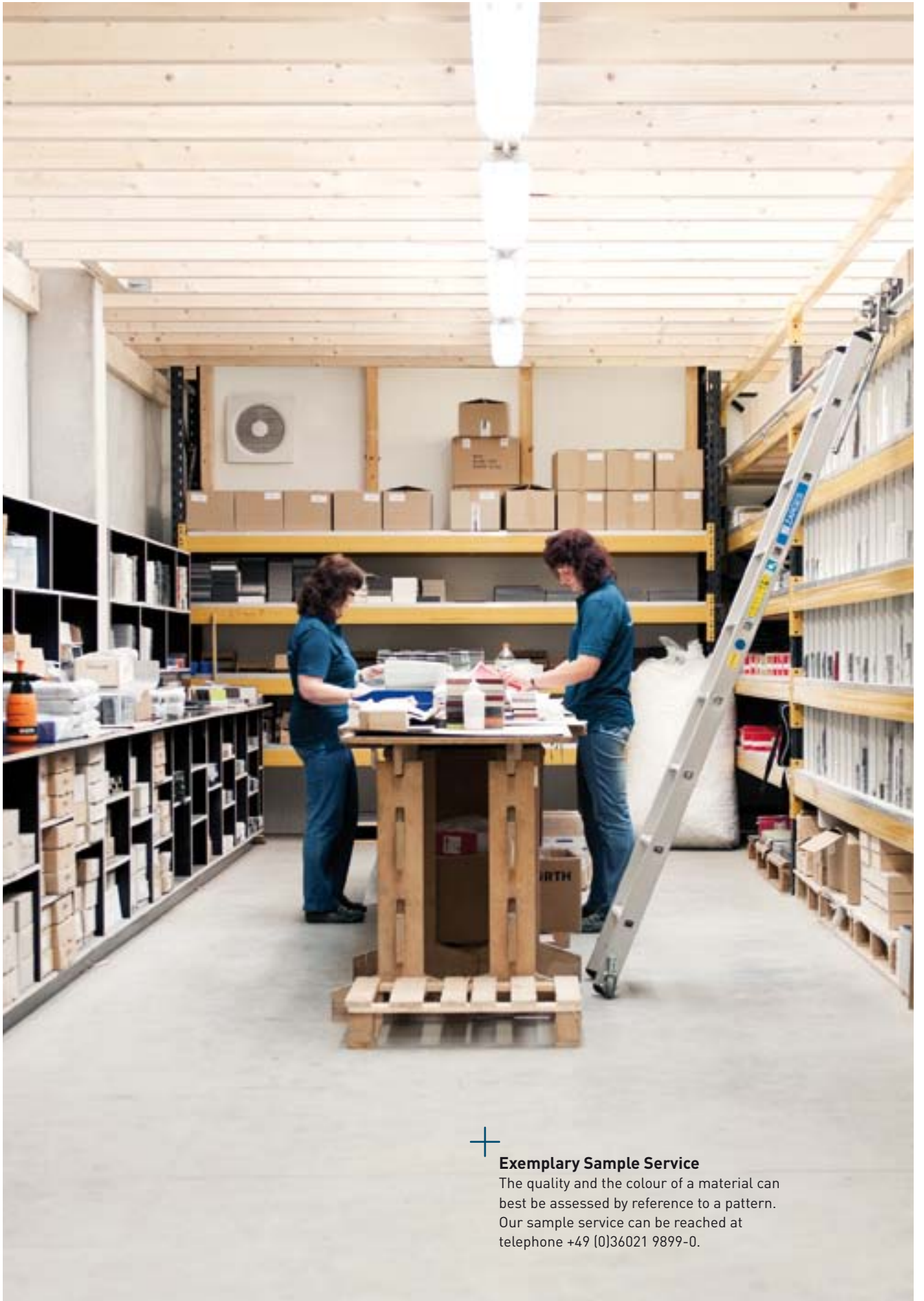

Exemplary Sample Service

The quality and the colour of a material can best be assessed by reference to a pattern.

Our sample service can be reached at telephone +49 (0)36021 9899-0.



Obermehler (1)
Competence Center
Quartz Material and Headquarters
Am Flugplatz 3
99996 Obermehler
Germany

Hennersdorf (2)
Competence Center
Solid Surface Material
Bahnhofstraße 16
09573 Augustusburg-Hennersdorf
Germany

Schlotheim (3)
Center of Logistics
Alltronikerstraße
99994 Schlotheim
Germany

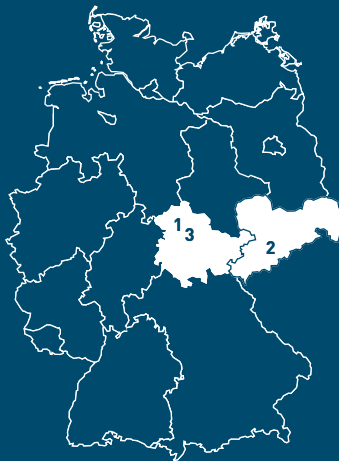

ROSSKOPF + PARTNER AG

Telephone +49 (0) 36021 9899-0 · **Telefax** +49 (0) 36021 9899-10 · **E-Mail** info@rosskopf-partner.com

REVISION STATUS 04/2016

We reserve the right to make engineering changes and will not be responsible for any errors. Previous Product Lists will no longer be valid after the release of this Product List.
Photography cover: Darius Ramazani | Photography inside pages: Darius Ramazani, diephotodesigner.de, Emanuel Raab, Fotowerkstatt Österreich, Jan Bitter, Mad Goodfellow, Mangelsdorfer Architekten, Marc Wilson Photography, Mauersberger
